

Les Commerces Le Séville

2183 Sainte-Catherine St W, Montréal, QC

Les Commerces Le Séville is a premium, mixed-use urban retail site located on the corner of Sainte-Catherine St. W. and Rue Lambert-Closse in the Shaughnessy Village neighbourhood of Downtown Montreal. Anchored by Marché Adonis, the retail area spans an entire city block, offering over 40,300 SF of prime, street-front space. In addition to Marché Adonis, the merchandising mix features a complimentary tenant roster of necessity-based retail including Bank of Montreal and Columbus Café.

Serviced by the Métro line and directly across from Atwater Station and Alexis Nihon Shopping Mall, this transit oriented site sees significant foot traffic in addition to the 200,000 people who reside in the immediate area.

A retail opportunity exists in a 1,189 SF corner end-cap unit, an opportunity for any brand to enhance their profile in downtown Montreal.

Possession Available immediately.

Size

Retail	40,300 s.f.
Residential	477 Units

Opened

2014

Underground Parking

32 parking stalls

Major Tenants

Marché Adonis	34,282 s.f.
BMO	2,943 s.f.
Café Columbus & Co.	1,883 s.f.



Demographics

	1km	3km	5km
Total Population	44,170	194,341	554,069
Number of Households	25,061	106,963	283,623
Average Household Income	\$103,641	\$117,665	\$109,258
Median Age	33.8	35.2	36.7

TRINITY - THE PLACE TO BE | 2025
trinity-group.com

77 Bloor Street West, Suite 1601
Toronto, ON Canada M5S 1M2
t: 416.255.8800 f: 416.255.8355

979 Bank Street, Suite 209
Ottawa, ON Canada K1S 5K5
t: 613.565.5864 f: 613.565.6380

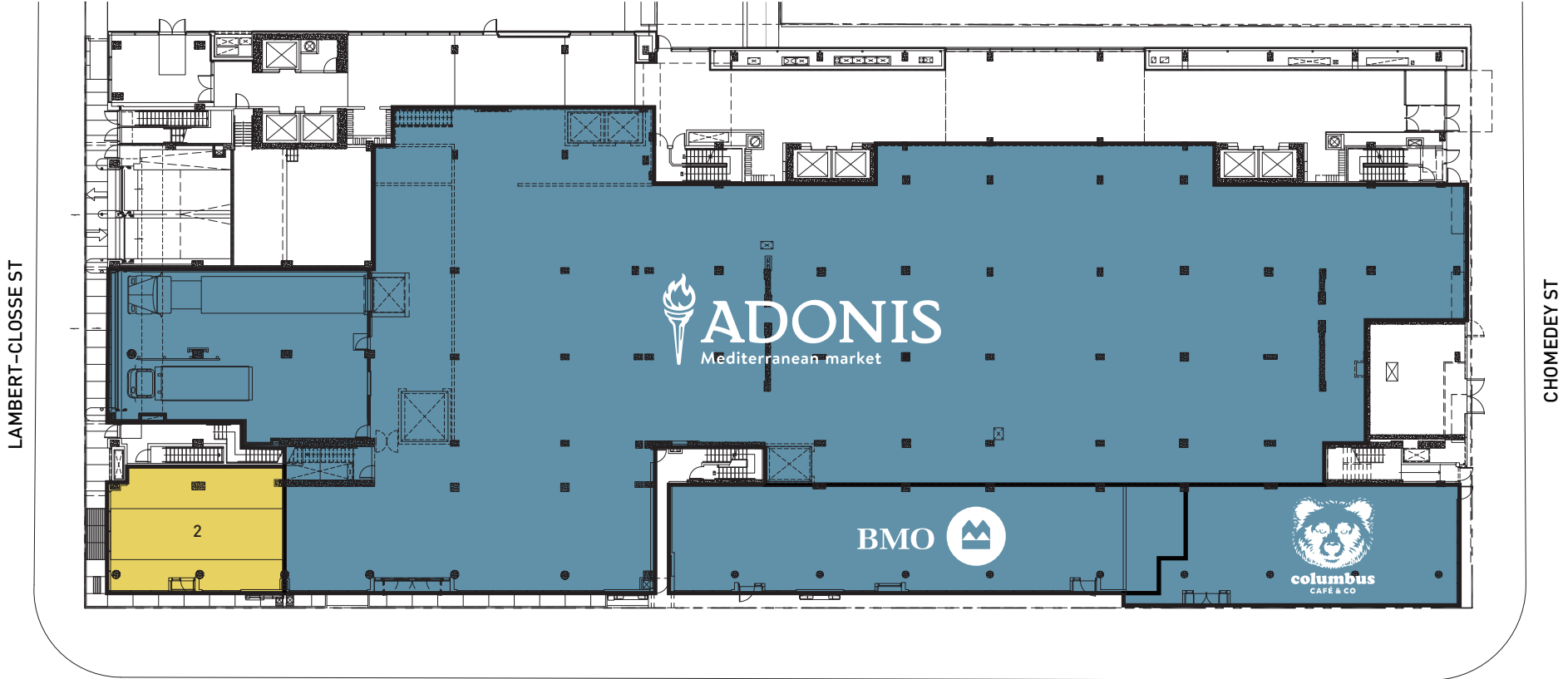

SAINTE-CATHERINE ST W

Tenants

- 1. Marché Adonis
- 2. Available 1,189 s.f.
- 3. BMO
- 4. Columbus Café

